

To mount the rotor

Rack-in-Rotor

- ① Make sure that there is no foreign material or water inside the chamber.

If any, remove or drain it away from the chamber.

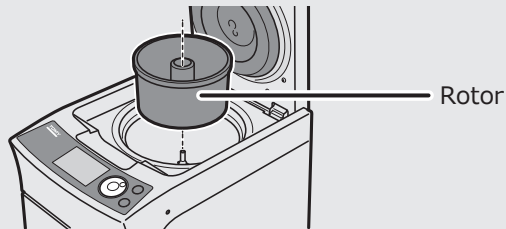

- ② Mount the rotor on the motor shaft.

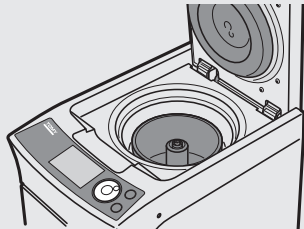

- ③ Mount the rotor fixing knob on the motor shaft peeping through the center hole of the rotor.

When the rotor is properly installed on the motor shaft, the rotor fixing screw is positioned upward.

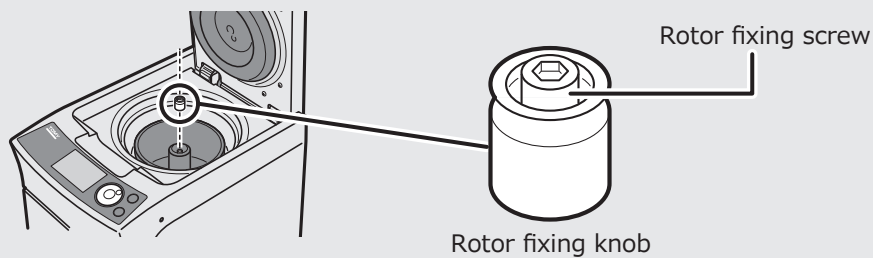

- ④ Lightly tighten the rotor fixing screw of the rotor fixing knob on the motor shaft by turning it clockwise using the attached standard hexagon wrench.

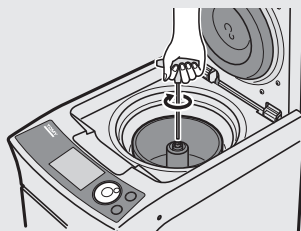

Hold and lift up the rotor with both hands and attempt to move it up and down to verify that the rotor is properly installed and seated on the shaft. If the rotor makes a clatter sound, firmly tighten the rotor fixing screw until the rotor does not make a clatter sound. After confirming no clatter sound from rotor, tighten the rotor fixing screw an additional 45 degree turn.